

# Gimpel™ Valves Parts List

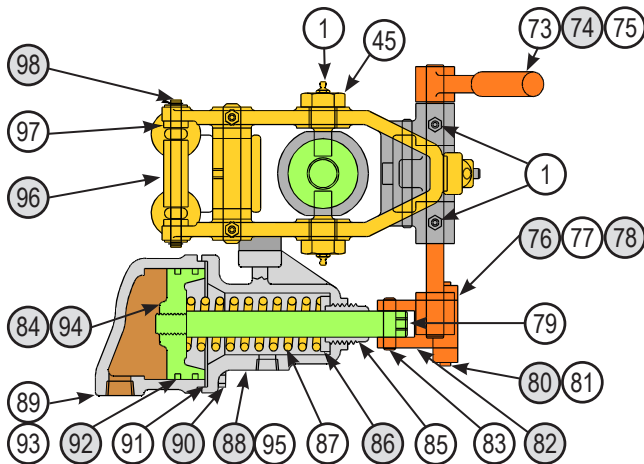
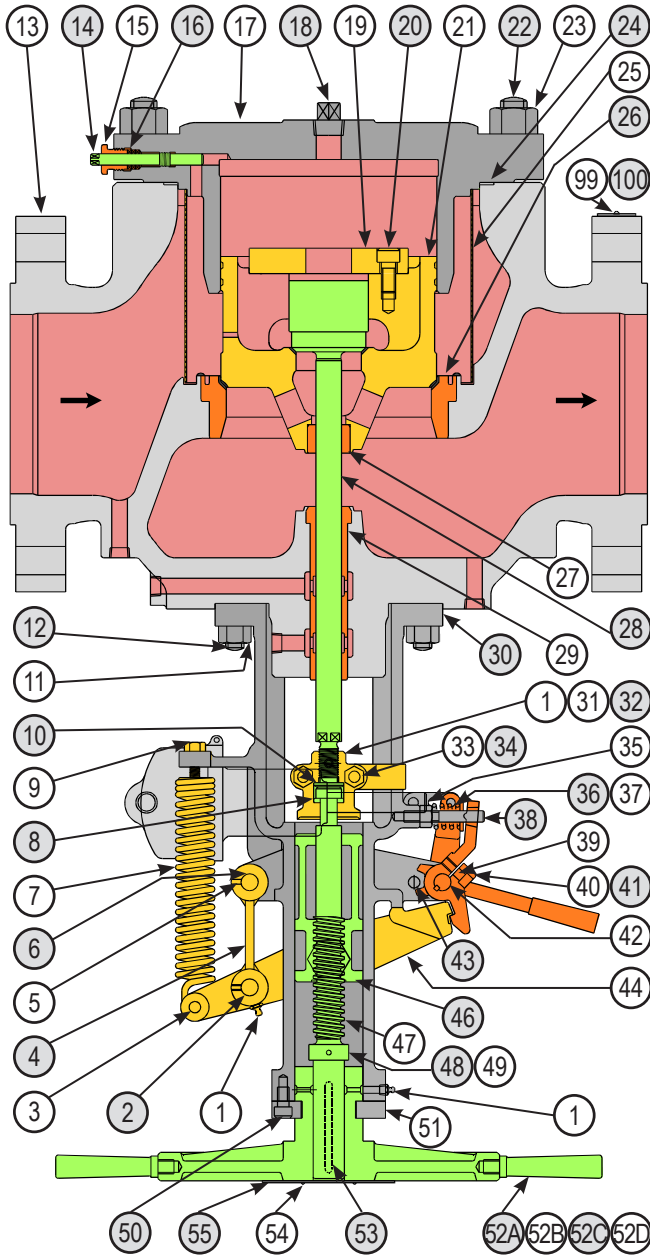

## Inverted Trip Throttle Valve

NPS 3 to NPS 20/150 to 900 Class

PC NO	DESCRIPTION	PC NO	DESCRIPTION
1	GREASE FITTING	45	TRUNNION SCREW
2	PIN, LINK	46	SLIDING NUT
3	PIN	47	SCREW SPINDLE
4	LINK	48	COLLAR, STOP
5	SET SCREW	49	PIN, TAPER
6	PIN, LINK	50	CAP SCREW
7	SPRING	51	FLANGE
8	WASHER SPLIT	52A	HANDWHEEL
9	SCREW, ADJUSTING	52B	HANDLE
10	WASHER, THRUST	52C	HUB
11	NUT, HEX	52D	SET SCREW
12	STUD	53	KEY
13	BODY	54	DRIVE SCREW
14	THROTTLE SCREW	55	NAME PLATE
15	GLAND	73	HAND TRIP*
16	PACKING	74	SET SCREW
17	COVER	75	KEY
18	PLUG, PIPE	76	TRIP CRANK
19	FLANGE, DISC	77	CAP SCREW
20	CAP SCREW	78	KEY
21	DISC	79	SET SCREW
22	STUD	80	PIN, STRAIGHT
23	NUT, HEX	81	PIN
24	GASKET	82	LINK, CONNECTING
25	STRAINER*	83	PIN
26	SEAT	84	STEM
27	BUSHING	85	NUT, TENSION
28	PILOT VALVE & STEM	86	WASHER
29	LEAKOFF BUSHING	87	SPRING
30	YOKE	88	CASING, SPRING
31	COUPLING, SPLIT	89	STUD
32	SET SCREW	90	NUT, HEX
33	BOLT, HEX	91	GASKET
34	NUT, HEX	92	RING, PISTON
35	NUT, HEX	93	OIL CYLINDER
36	SPRING	94	PISTON
37	WASHER	95	BOLT, HEX HD.
38	STUD, SPRING	96	SPACER
40	TRIP HOOK	97	SPACER
41	KEY	98	PIN, COTTER
42	SHAFT, TRIP HOOK	99	PLATE TURBINE END
43	PIN, STOP	100	DRIVE SCREW
44	LATCH UP LEVER		

**NOTE:**

When ordering spare parts refer to order numbers stamped on nameplate PC 55.

\* Furnished only when specified: strainer PC 25, hand trip PC 73.

### Gimpel™ Valves Parts List Inverted Trip Throttle Valve with Hard Packing

**DRESSER-RAND**

DRAWING  
NUMBER

**S-1054**

REV  
**C**